



**JDENTAL CARE**

*just smile*



MADE IN ITALY

Dental Implant

# JDNASAL

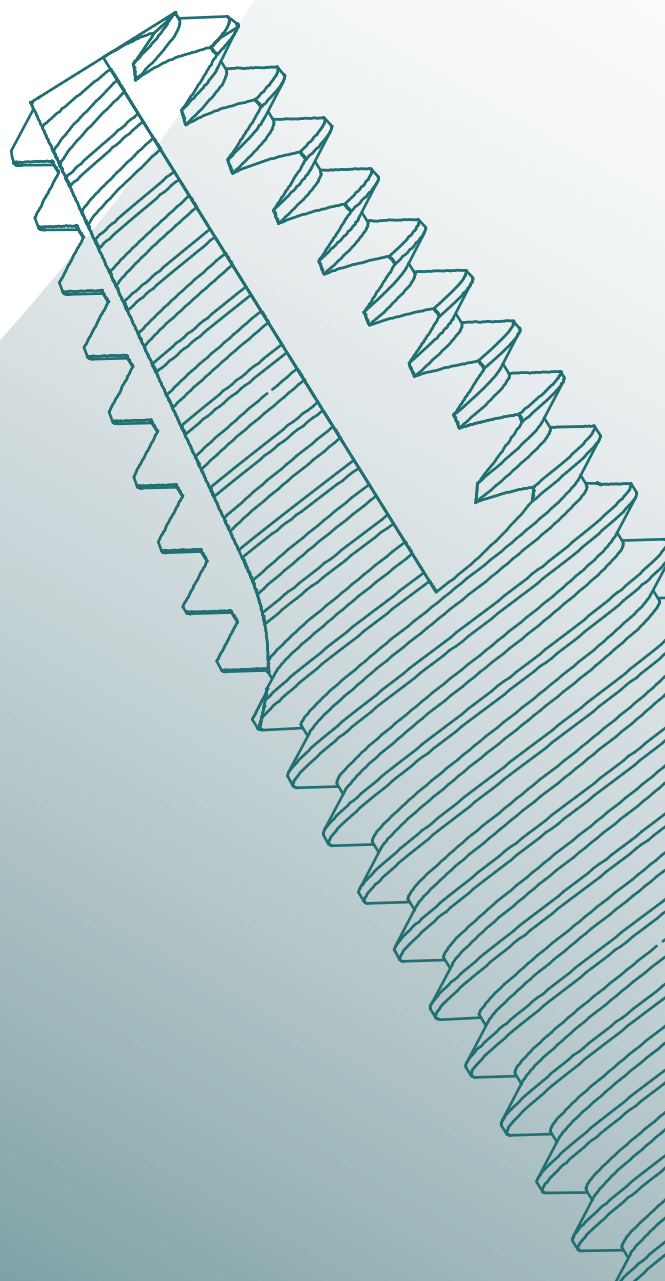
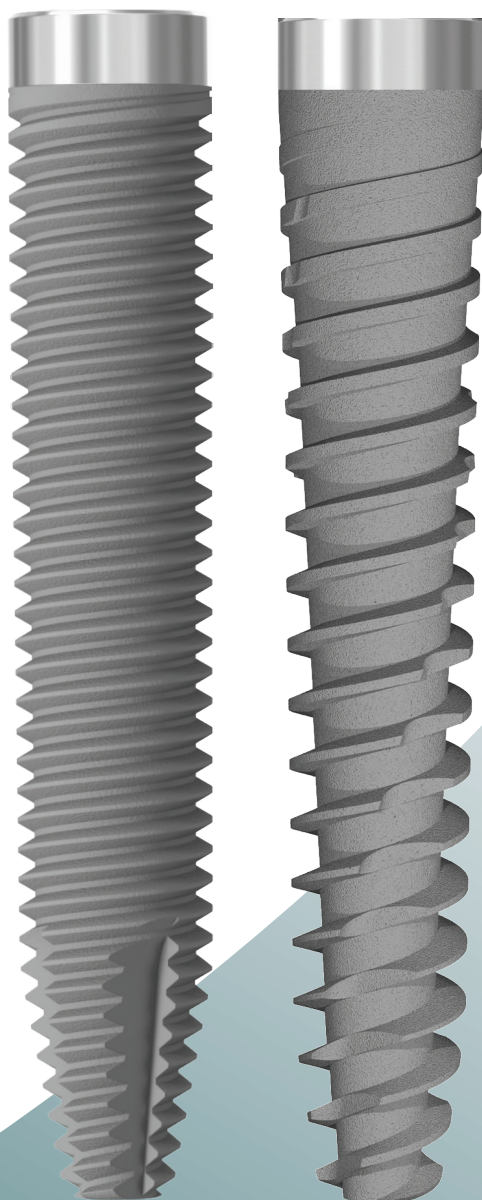

Nasal Anchorage

# JD NASAL

## NASAL ANCHORAGE.

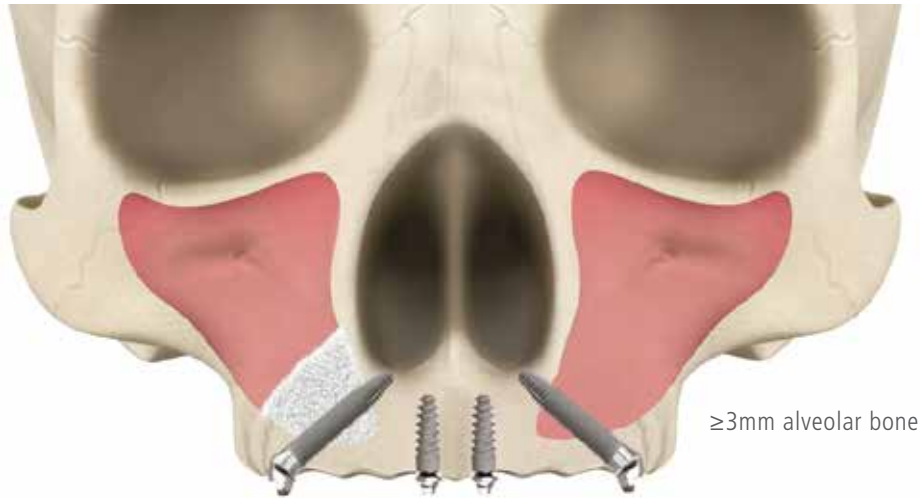

In a severely resorbed maxilla Nasal Implants can be used to make use of the nasal bone. JDNasal vImplants enable use of the maxillary bone surrounding the nose. The implant site begins in the alveolar bone at the pre-molar and ends in the bone separating the maxillary sinus and nasal cavity. The specialized implants need to be extra-long to span across the sinus and they need to be angulated. JDNasalImplant is available up to a length of 26mm. Full product details and drilling protocol follow overleaf. The surgeon can choose to add a bone graft or not. It is mandatory to have no signs of sinus infection before deciding to proceed with this procedure.

## PRODUCT SPECIFICATIONS.

The JDNasal dental implant is available in the diameter and lengths shown in this chart:

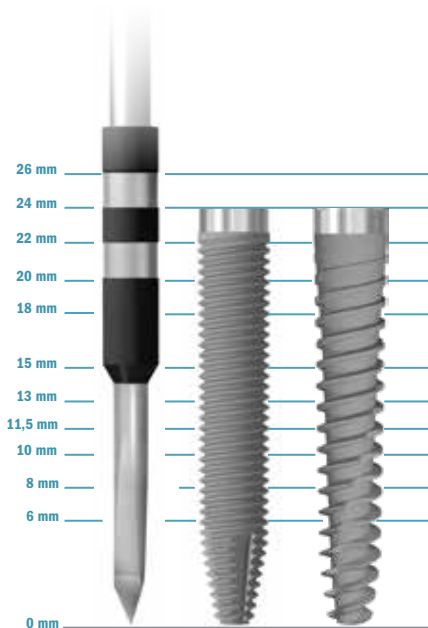

IMPLANT DIAMETER	TIP DIAMETER	LENGTH			
Ø 4.0	2.4	20	22	24	26

**Note:**  
All dimensions are expressed in millimetres.

## SITE PREPARATION SEQUENCE.

### Non-guided protocol.

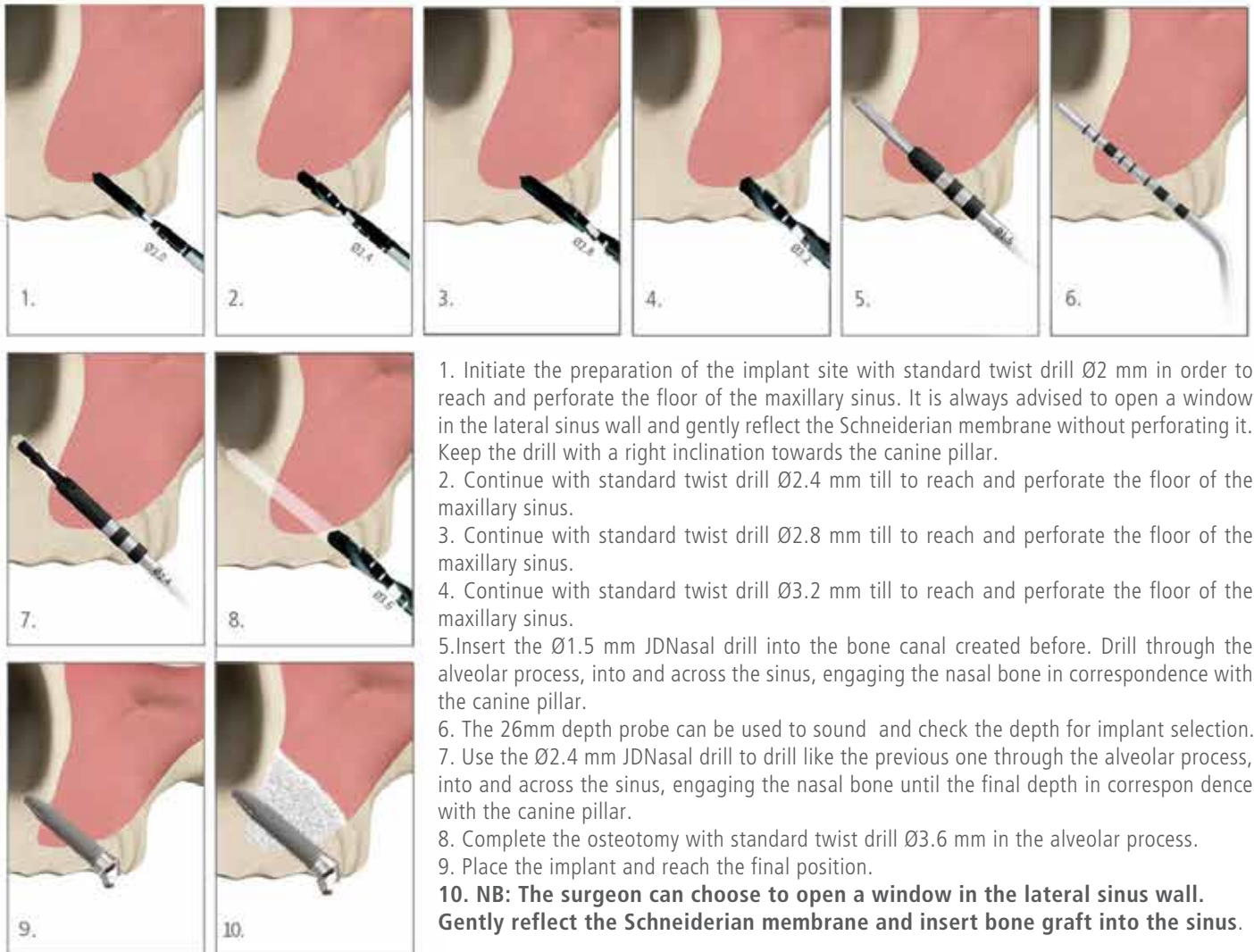

1. Initiate the preparation of the implant site with standard twist drill Ø2 mm in order to reach and perforate the floor of the maxillary sinus. It is always advised to open a window in the lateral sinus wall and gently reflect the Schneiderian membrane without perforating it. Keep the drill with a right inclination towards the canine pillar.
2. Continue with standard twist drill Ø2.4 mm till to reach and perforate the floor of the maxillary sinus.
3. Continue with standard twist drill Ø2.8 mm till to reach and perforate the floor of the maxillary sinus.
4. Continue with standard twist drill Ø3.2 mm till to reach and perforate the floor of the maxillary sinus.
5. Insert the Ø1.5 mm JDNasal drill into the bone canal created before. Drill through the alveolar process, into and across the sinus, engaging the nasal bone in correspondence with the canine pillar.
6. The 26mm depth probe can be used to sound and check the depth for implant selection.
7. Use the Ø2.4 mm JDNasal drill to drill like the previous one through the alveolar process, into and across the sinus, engaging the nasal bone until the final depth in correspondence with the canine pillar.
8. Complete the osteotomy with standard twist drill Ø3.6 mm in the alveolar process.
9. Place the implant and reach the final position.
- 10. NB: The surgeon can choose to open a window in the lateral sinus wall. Gently reflect the Schneiderian membrane and insert bone graft into the sinus.**

Longer twist drills Ø 2mm and Ø2.4 mm for nasal implants are available in order to reach directly the nasal bone reducing the drilling steps. Make sure to be able to maintain the right inclination towards the canine pillar.

### Computer guided protocol.



1. Start the osteotomy using the first JDGuided Drill Ø 2.4 x L 6 mm.
2. Continue using JDNasal Guided Drill Ø 2.0 at the same implant length to be inserted (Choose among JDNasal Guided drills L 20-22-24-26 mm).
3. Continue using JDNasal Guided Drill Ø 2.4 at the same implant length to be inserted (Choose among JDNasal Guided drills L 20-22-24-26 mm).
4. Continue with JDGuided Drill Ø2.8 x L 6 mm.
5. Continue the osteotomy with JDGuided Drill Ø3.2 x L 6 mm.
6. Complete the osteotomy with JDGuided Drill Ø3.6 x L 6 mm.

## SITE PREPARATION SEQUENCE.

### Non-guided protocol.

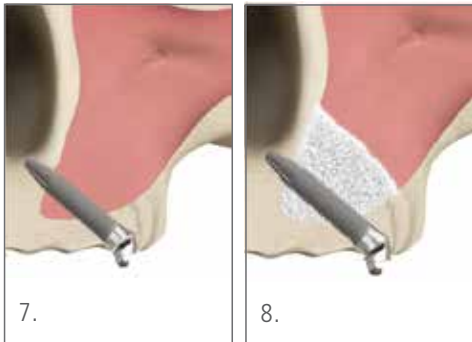
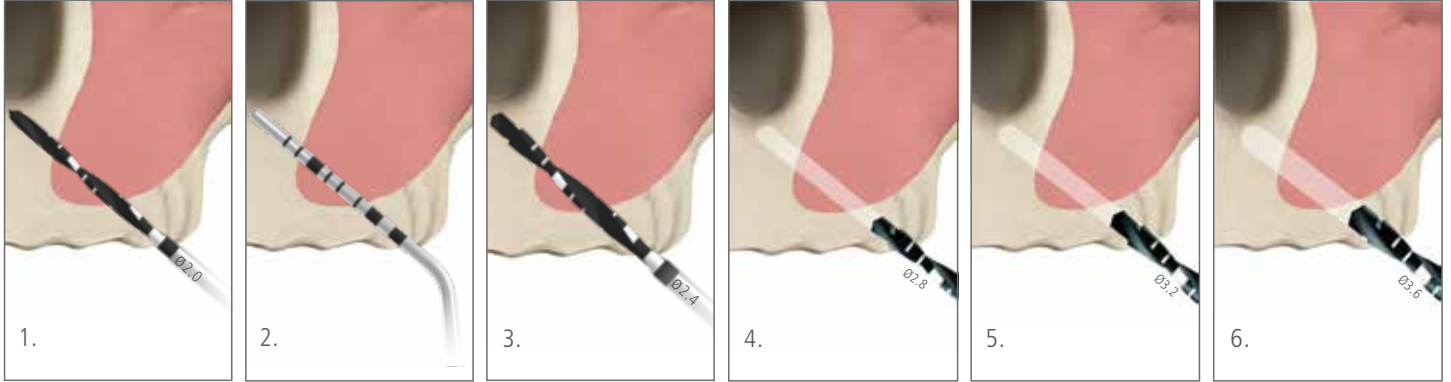

0. Initiate the site preparation with the Ø2mm JDNasal drill through the alveolar bone. It is advised to open a window in the lateral sinus wall and gently reflect the Schneiderian membrane without perforating it.
1. If the alveolar has more than 3mm of good bone, use the Ø2mm JDNasal drill to drill through the alveolar, into and across the sinus, engaging the lateral nasal wall. It is optional to reflect the Schneiderian membrane of the sinus.
2. The 26mm depth probe can be used to palpate the hole depth for implant selection.
3. Drill to final depth with the Ø2.4mm JDNasal drill.
4. Continue with standard twist drill Ø2.8 mm at the entrance for 6 mm.
5. Continue the osteotomy with standard twist drill Ø3.2 mm at the entrance for 6 mm.
6. Complete the osteotomy with standard twist drill Ø3.6 mm at the entrance for 6 mm.
7. Place the implant till to reach the final position.
8. **NB: The surgeon can choose to open a window in the lateral sinus wall. Gently reflect the Schneiderian membrane and insert bone graft into the sinus.**

## PRODUCT CATALOGUE.

### Implants:

NA40200:	JDNasal	Ø 4.0 L 20
NA40220:	JDNasal	Ø 4.0 L 22
NA40240:	JDNasal	Ø 4.0 L 24
NA40260:	JDNasal	Ø 4.0 L 26



NAE40200:	JDNasal	Evo Ø 4.0 L 20
NAE40220:	JDNasal	Evo Ø 4.0 L 22
NAE40240:	JDNasal	Evo Ø 4.0 L 24
NAE40260:	JDNasal	Evo Ø 4.0 L 26

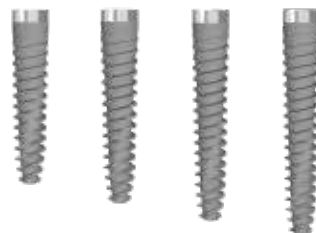

### Drills and Depth probe:

JDNPR	26mm depth probe JDNasal
JDDR20L	Long Twist Drill Ø 2.0 JDNasalC
JDDR24L	Long Twist Drill Ø 2.4 JDNasalC

JDIDNA	Initial Drill JDNasal Ø 1.5
JDDRNA24	Drill Ø 2.4 JDNasal

JDDR20	Twist Drill Ø 2.0
JDDR24	Twist Drill Ø 2.4
JDDR28	Twist Drill Ø 2.8
JDDR34	Twist Drill Ø 3.4
JDDR36	Twist Drill Ø 3.6



### Guided Drills for JDNasal guided protocol:

JDGD20-200	Guided Drill Ø 2.0 L 20 JDNasal
JDGD24-200	Guided Drill Ø 2.4 L 20 JDNasal
JDGD20-220	Guided Drill Ø 2.0 L 22 JDNasal
JDGD24-220	Guided Drill Ø 2.4 L 22 JDNasal
JDGD20-240	Guided Drill Ø 2.0 L 24 JDNasal
JDGD24-240	Guided Drill Ø 2.4 L 24 JDNasal
JDGD20-260	Guided Drill Ø 2.0 L 26 JDNasal
JDGD24-260	Guided Drill Ø 2.4 L 26 JDNasal



### JD Nasal Surgical Kit:

JDNAKF	JDNasal Kit Full
--------	------------------

### Prosthetic Solutions:

JDNasal connection is compatible with JDEvolution Plus+, so please refer to this catalog for choosing the correct prosthetic piece.